

Clearances:

"A" = Horizontal distance to adjacent surface
100mm if smooth, 325mm if irregular

Anchors

Horizontal & Vertical 2 minimum (see installation information) for further details of substrate requirements and type

Platform Floor Finish

Standard - Aluminium Chequer Plate
Special - Altro walking 20

Electrical Supply (Main switch)

1ph L, N, PE, 3 x 2,5mm² 16A

Technical Data

Rated capacity: 300kg / 2 Persons

Speed: 0,08m/s

Drive: 2,5 kw Electrical Motor / Belt drive

Electrical Connection: Single phase, 3 x 1,5mm²

(By use of heater the cable area should be increased to 2,5mm²)

Control Voltage: 24 Volts

Soft Start / Stop by frequency inverter

Drive system: Screw / nut, dubble

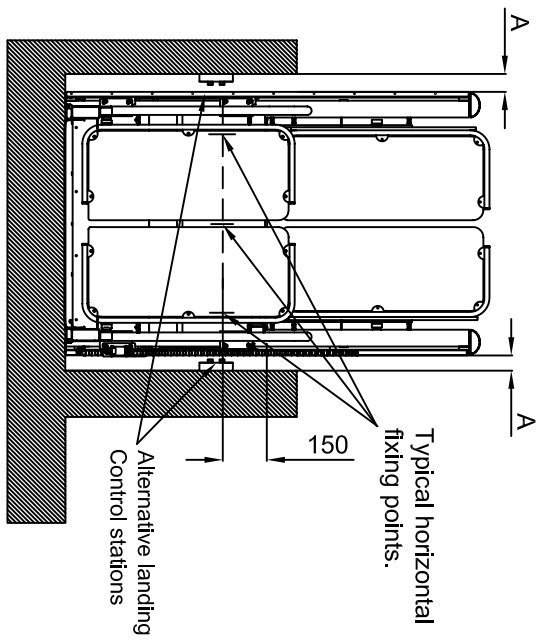
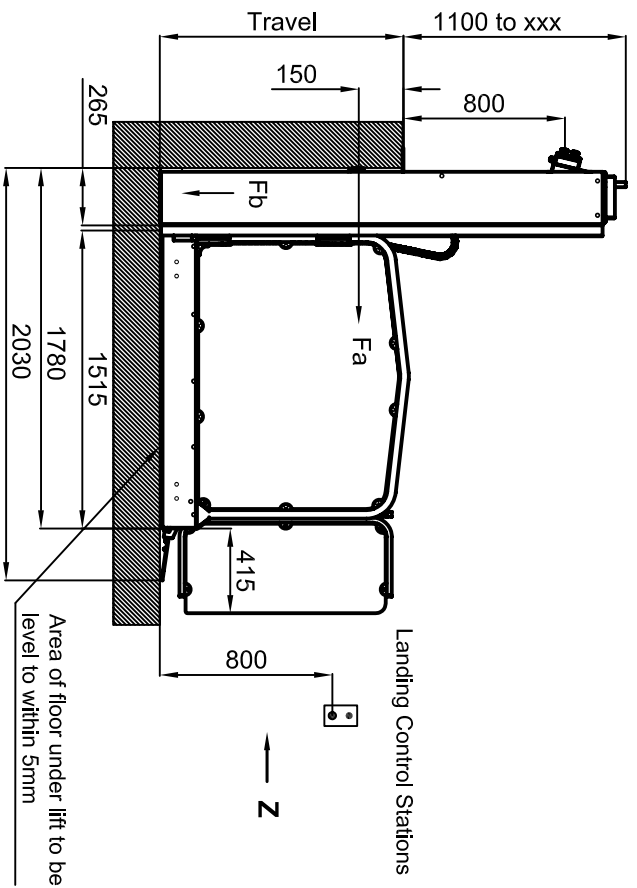

View Z

HORIZONTAL FORCES	
Fixing height mm	Total Anchor Force Fa, kN
400	21,5
600	17,0
800	14,5
1000	11,0
1200	8,5
1400	7,5
1600	6,5
1800	5,5
2000	4,5
2200	4,0
2400	3,5
2600	3,25
2800	3,0

Fb = Vertical force of 10kn, spread over area of 1300mm x 250mm.

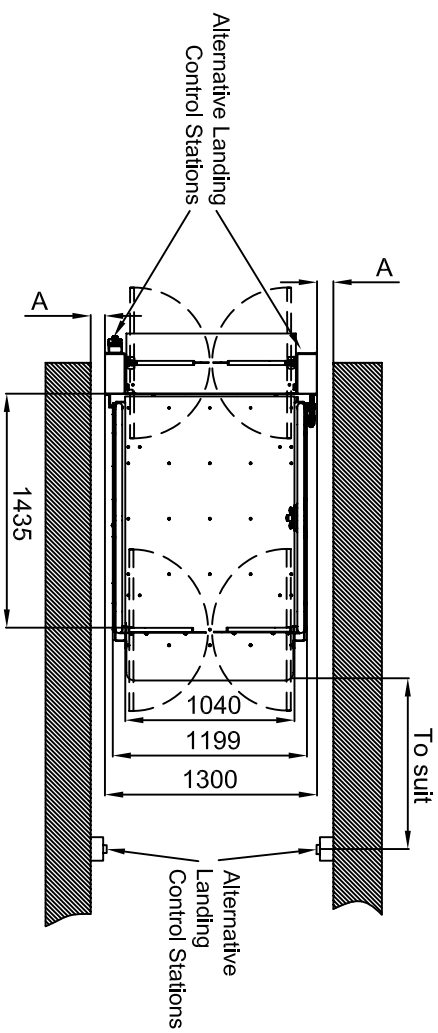

Artid	Vardnummer	Namn	Ljftshöjd	Material	Namn	Rfd.
			2100mm			
<p>MPPR Arden 4 Arbiv S-23291 Arbiv SWEDEN Tel. +46 40 437075 Fax +46 40 432344</p>						
Datum	Revision	Titel		Revision By		
10.05.12	C	MPPR STRATEGOS III		MPPR STRATEGOS III		
		STANDARD		STANDARD		
				Ritning nr:		